

MASS TIMBER | LAMINATE | INSONOFLOOR (SOPREMA), FERMACELL 2E32 | FLOATING

Acoustic performance
AIIIC: 43 to 46
ASTC: 39 to 41

ASSEMBLY DETAILS

STRUCTURE

Mass timber

ASSEMBLY COMPONENTS

Insonofloor (Soprema), Fermacell 2E32

FLOOR TYPE

Laminate

INSTALLATION TYPE

Floating

CEILING TYPE

None

NUMBER OF GYPSUM

0

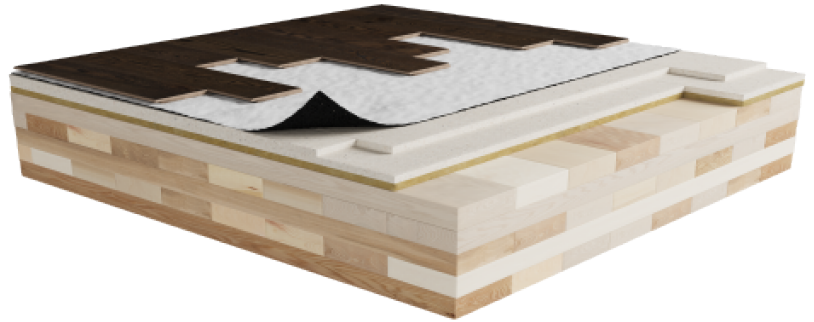

INSONOFLOOR (SOPREMA)



[Plus de détails](#)

FERMACELL 2E32

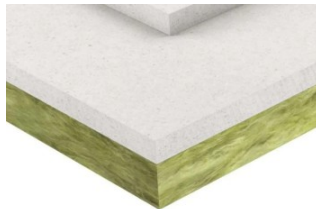

[Plus de détails](#)