

## LIGHT WOOD | WOOD | FERMACELL 2E32, 5/8" T&G PLYWOOD, ACOUSTITECH VP | FLOATING

Acoustic performance  
AIIIC: 55 to 59  
ASTC: 56 to 59

### ASSEMBLY DETAILS

#### STRUCTURE

Light wood

#### ASSEMBLY COMPONENTS

Fermacell 2E32, 5/8" T&G plywood,  
AcoustiTECH VP

#### FLOOR TYPE

Wood

#### INSTALLATION TYPE

Floating

#### CEILING TYPE

Resilient channels

#### NUMBER OF GYPSUM

2



### FERMACELL 2E32

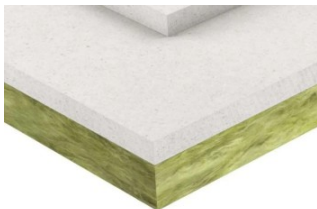

[Plus de détails](#)

### ACOUSTITECH VP



[Plus de détails](#)